

GROOVED EQUAL TEE GT

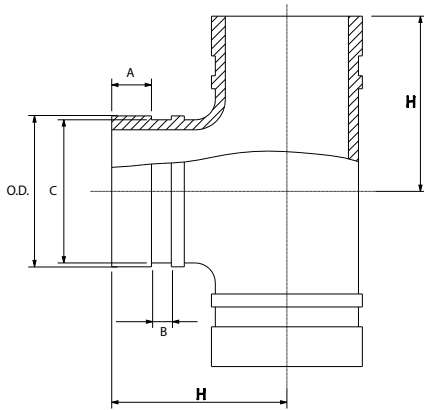

Grooved equal tees provide an economical and efficient method of changing direction and adding an outlet in piping systems.

Reference		Nominal size		Pipe Ø O.D.	Grooved equal tee dimensions				Weight	Marking
Red	Galva	NPS inch	DN mm	mm	H mm	A mm	B mm	C mm	kg	
GTR	GTG	1	25	33,7	57	15,9	7,9	30,2	0,40	GT
GTR	GTG	1¼	32	42,4	70	15,9	7,9	39,0	0,60	GT
GTR	GTG	1½	40	48,3	70	15,9	7,9	45,1	0,74	GT
GTR	GTG	2	50	60,3	70	15,9	7,9	57,2	0,92	GTS
GTR	GTG	2½	65	73,0	76	15,9	7,9	69,1	1,56	GTS
GTR	GTG	2½	65	76,1	76	15,9	7,9	72,3	1,45	GTS
GTR	GTG	3	80	88,9	85	15,9	7,9	84,9	1,82	GTS
GTR	GTG	4	100	108,0	102	15,9	9,5	103,7	2,56	GTS*
GTR	GTG	4	100	114,3	102	15,9	9,5	110,1	2,57	GTS
GTR	GTG	5	125	133,0	121	15,9	9,5	129,1	4,80	GTS*
GTR	GTG	5	125	139,7	121	15,9	9,5	135,5	4,63	GTS
GTR	GTG	5	125	141,3	121	15,9	9,5	137,0	5,00	GTS
GTR	GTG	6	150	159,0	130	15,9	9,5	154,5	5,60	GTS*
GTR	GTG	6	150	165,1	130	15,9	9,5	160,8	5,77	GTS
GTR	GTG	6	150	168,3	140	15,9	9,5	164,0	6,40	GTS
GTR	GTG	8	200	219,1	175	19,1	11,1	214,4	12,35	GTS
GTR	GTG	10	250	273,0	215	19,1	12,7	268,3	17,40	GTS
GTR	GTG	12	300	323,9	220	19,1	12,7	318,3	23,50	GTS
GTR	GTG	14	350	356,0	245	23,8	15,9	350,8	49,30	GTS**
GTR	GTG	16	400	406,4	285	23,8	15,9	400,8	59,60	GTS**

Material specifications

Housing: ductile iron in accordance with ASTM A536 GR 65-45-12

Coating:

- Hot dip galvanized
- Red paint coating RAL 3000, EPD Epoxy coating

Working pressure

300 PSI/2068 kPa/20,7 barg

General notes:

- * No UL-approval / ** No FM- and UL-approval.
- Pressure ratings listed are CWP (cold working pressure) or MWP (maximum working pressure) at a maximum service temperature of 50°C. This rating may occasionally differ from maximum working pressure listed and/or approved by UL and/or FM, as testing conditions and test pipes can differ. For more information, please contact info@pipinglogistics.eu.
- Maximum working pressure listed is the total of internal and external pressures based on standard weight (ANSI) steel pipe and standard roll or cut groove in accordance with Profit specifications. For more information, please contact info@pipinglogistics.eu.
- For one time field test only, the maximum joint working pressure may be increased by 150% the figure shown.
- Warning: Piping systems must always be depressurized and drained before attempting disassembly and/or removal of any components.
- Profit reserves the right to change specifications, designs and/or standard equipment without notice and without incurring in any obligations.
- Profit red coated products are intended for piping with indoor application (EN 12944-2 corrosivity category C1 & C2). For outdoor installations near the sea (corrosivity category C3) we advise the use of our hot dip galvanized couplings and fittings. For application in corrosivity category C4 (higher salinity climate) or higher, please contact info@pipinglogistics.eu.
- We advise to always store our products in closed and dry environments.